

Power is our commodity, the world is our market !

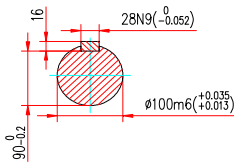
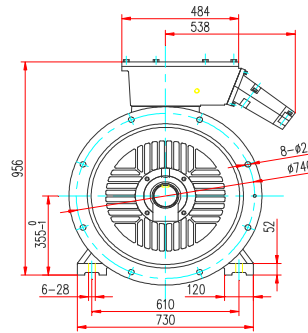
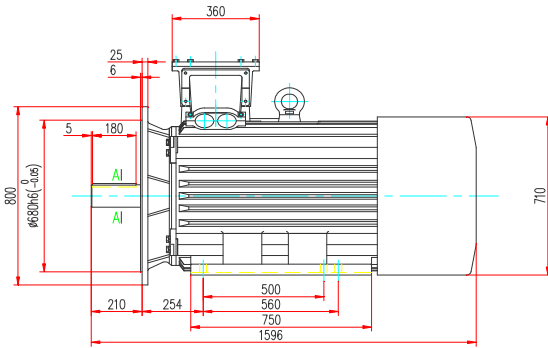

Specification	IEC60034-1
Manufacturer	Dutchi Motors BV
Motor type	DM1-IE2-355MX6
Rated power	200 kW S1 Duty
Speed	990 r.p.m.
Voltage	400 / 690 V
Frequency	50 Hz
Connection	Δ / Y
Amps full load	343 / 198 A
Amps no load	103 A
Enclosure	IP55
Insulation class	F (temp. rise B (80 K))

Max coolant temp.	40 °C
Max altitude	1000 m above sea level
Comment	3 x PTC150 °C

Feature	Cast-iron motor
Weight	1770 kg

Warranty	12~18 months
----------	---------------------

Efficiency class	IE2			
Load data	100%	75%	50%	25%
Efficiency	95	95,1	94,6	91,6 %
Power factor	0,88	0,86	0,79	0,62

Sound pressure level(1m)	70,5 dB(A)
Resistance R20(open)	0,017 Ω
Resistance R20	Δ 0,011 Ω

Full load torque	1925 Nm
DOL Starting torque vs FL torque	1,97
DOL Pull up torque vs FL torque	1,52
DOL Pull out torque vs FL torque	3,17
Star-Delta Starting torque vs FL torque	0,61
Star-Delta Pull up torque vs FL torque	0,47
Star-Delta Pull out torque vs FL torque	0,99
DOL Starting current vs FL current	7,23
Star-Delta Starting current vs FL current	2,26
Rotor Inertia [J]	10,7 kgm ²

Bearing DE	6322 C3
Bearing NDE	6320 C3

WI	Change		date	sign
Dutchi Motors B.V. P.O. Box 5390 NL-6802EJ Arnhem tel: +31-(0)26 - 3541 600 fax: +31-(0)26 - 3541 650		Description	date	sign
		generated	10-jun-10	
		dutchi.motors@dutchi.nl www.dutchi.com		

